

AUTOMOTIVE

Automotive | Automobile

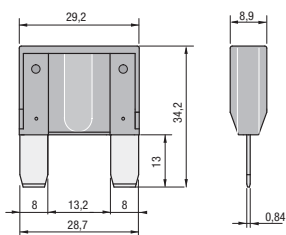

FUSIBILI ML MAXI LAMA

ML maxi blade fuses | Maxi-fusibles à lame ML

Caratteristica	Characteristic	Caractéristique
T= ritardati	T= time delay	T= temporisés
Tensione 32 Vdc	Voltage 32 Vdc	Tension 32 Vdc
Capacità di rottura 1000 A	Breaking capacity 1000 A	Pouvoir de coupure 1000 A
Contatto A lama	Contacts Blade	Contact À lame
Corpo Plastica colorata	Body Coloured plastic	Corps Plastique coloré
Norme riferimento SAE - J 1888	Standards SAE - J 1888	Normes SAE - J 1888



TEMPI DI FUSIONE | Time current | Temps de fusion

Corrente nominale In Rated current Courant nominal	Corrente di prova Test current Courant d'essai			
	1,1xIn	1,35xIn	2xIn	6xIn
20 A - 120 A	> 100 h	60 s - 3600 s	2 s - 60 s	40 ms - 1 s

Corrente nominale Rated current Courant nominal	Codice Code Code	Tensione Voltage Tension	Colore Colour Couleur
20 A	ML32.20	32 Vdc	Yellow
25 A	ML32.25	32 Vdc	Grey
30 A	ML32.30	32 Vdc	Green
35 A	ML32.35	32 Vdc	Brown
40 A	ML32.40	32 Vdc	Orange
50 A	ML32.50	32 Vdc	Red
60 A	ML32.60	32 Vdc	Blue
70 A	ML32.70	32 Vdc	Light Blue
80 A	ML32.80	32 Vdc	White
100 A	ML32.100	32 Vdc	Purple
120 A	ML32.120	32 Vdc	Dark Red



a richiesta sono fornibili con LED
they are available with led upon request
sur demande on peut les fournir avec led

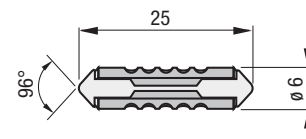

FUSIBILI AC

AC fuses | Fusibles AC

Dimensioni	Dimensions	Dimensions
6x25 mm	6x25 mm	6x25 mm
Tensione 32 Vdc	Voltage 32 Vdc	Tension 32 Vdc
Contatto Conico	Contact Tapered	Contact Conique
Corpo Plastica	Body Plastic	Corps Plastique
Norma riferimento FIAT 9.91806	Standards FIAT 9.91806	Normes FIAT 9.91806



TEMPI DI FUSIONE | Time current | Temps de fusion

Corrente nominale In Test current Courant nominal	Corrente di prova Test current Courant d'essai	
	1,5xIn	2,5xIn
5 A - 40 A	> 1 h min	60 s max

Corrente nominale Rated current Courant nominal	Codice Code Code	Colore Colour Couleur
5 A	AC05	Yellow
8 A	AC08	Grey
10 A	AC10	White
16 A	AC16	Green
25 A	AC25	Brown
40 A	AC40	Red

